

ALTERNATORI TRIFASE - 2 Poli

THREE-PHASE ALTERNATORS - 2 Poles

Z100

A spazzole e compound
Brush with Compound

ZR100

A spazzole con AVR-d
Brush with AVR-d

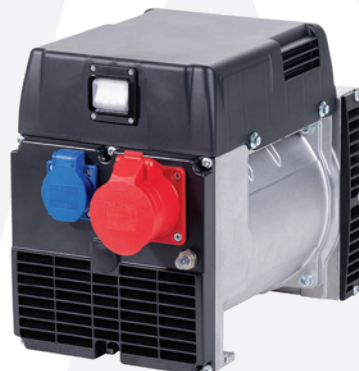

Caratteristiche tecniche
Z100
Tensione standard 50Hz: 230/400V, 240/415V 60Hz: 127/220V, 220/380V Altri valori a richiesta
Classe d'isolamento H
Protezione IP 23
T.H.D. ≤ 6%
Precisione tensione ± 6% (cosφ = 0,9)
Capacità di spunto (Icc ≥ 4In)
Optional Quadro elettrico, Carica batterie
ZR100
Tensione standard 50Hz: range 230÷240/400÷415V 60Hz: 127/220V, 220/380V Altri valori a richiesta
Classe d'isolamento H
Protezione IP 23
T.H.D. ≤ 6%
Precisione tensione ± 1,5% (indipendentemente dal cosφ)
Capacità di spunto (Icc ≥ 3In)
Optional Quadro elettrico, Carica batterie
Regolatore automatico di tensione AVR960D • Provvisto di protezioni per Sottovelocità, Massima tensione, Massima corrente di eccitazione, Sovraccarico prolungato (max kVA) • Possibilità di regolare la tensione a distanza

Technical characteristics
Z100
Standard voltage 50Hz: 230/400V, 240/415V 60Hz: 127/220V, 220/380V Other voltages on request
Insulation class H
Protection IP 23
T.H.D. ≤ 6%
Voltage accuracy ± 6% (cosφ = 0,9)
Starting capacity (Icc ≥ 4In)
Optional Electrical panel, Battery charger
ZR100
Standard voltage 50Hz: range 230÷240/400÷415V 60Hz: 127/220V, 220/380V Other voltages on request
Insulation class H
Protection IP 23
T.H.D. ≤ 6%
Voltage accuracy ± 1,5% (regardless of cosφ)
Starting capacity (Icc ≥ 3In)
Optional Electrical panel, Battery charger
Automatic Voltage Regulator AVR960D • Supplied with protections for Underspeed, Maximum voltage, Maximum excitation current, Prolonged overload (max kVA) • Remotely adjustable voltage regulator

Modello Model	Potenza Output Power		Potenza assorbita Driving Power		Potenza Output Power		Potenza assorbita Driving Power		Peso Weight		
	3 ph cosφ 0,8 [kVA]	1 ph Y cosφ 1 [kVA]	4/4 - cosφ 0,8 [kW] η %		3 ph cosφ 0,8 [kVA]	1 ph Y cosφ 1 [kVA]	4/4 - cosφ 0,8 [kW] η %		cone [kg]	B34 [kg]	SAE [kg]
	50Hz - 3000rpm				60Hz - 3600rpm						
Z100 SB	6,0	2,7	6,1	79,0	7,5	3,7	7,5	80,0	28,5	30,0	32,0
Z100 SC	7,0	3,5	7,0	80,0	9,0	4,5	8,9	81,0	30,0	31,5	33,5
Z100 SCM	7,0	4,0	7,0	80,5	---	---	---	---	30,5	32,0	34,0
Z100 LA	8,5	4,5	8,3	82,0	11,0	5,5	10,6	83,0	36,0	37,5	39,5
Z100 LB	10,0	5,0	9,5	84,0	13,0	6,5	12,2	85,0	40,0	41,5	43,5
ZR100 SA	5,5	2,7	5,7	77,0	7,0	3,5	7,2	78,0	25,0	26,5	28,5
ZR100 SC	7,0	3,5	6,9	81,0	9,0	4,5	8,8	82,0	27,0	28,5	30,5
ZR100 LA	8,5	4,5	8,2	83,0	11,0	5,5	10,5	84,0	33,0	34,5	36,5
ZR100 LB	10,0	5,0	9,4	85,0	13,0	6,5	12,1	86,0	37,0	38,5	40,5

Dimensioni di ingombro

Overall Dimensions

CONE

J609b

C 22
C 25,4
C 35

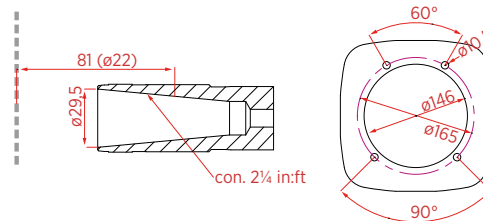
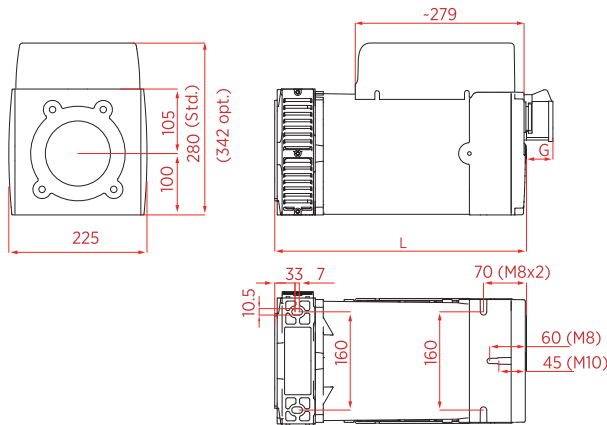

C 23 C 30

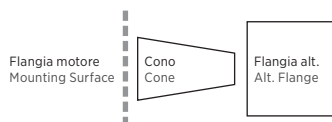
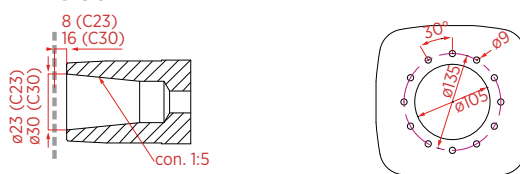

B34

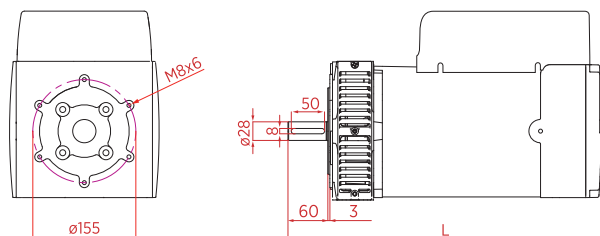

SAE

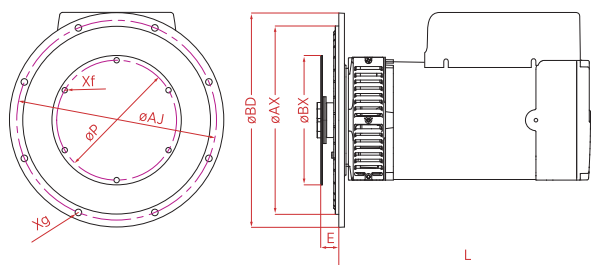

SAE	Flangia Flange			
	ØBD	ØAX	ØAJ	Xf
	(mm)			
5	358	314,33	333,4	Ø11 (8)
4	405	361,95	381,0	Ø11 (12)

SAE	Giunto Joint			
	ØBX	ØP	E	Xg
	(mm)			
6,5	215,9	200,02	30,2	Ø9 (6)
7,5	241,3	222,25	30,2	Ø9 (8)

	cone	B34	SAE
	L		
	(mm)		
Z-ZR100 S-	345	408	357
Z-ZR100 L-	410	473	422

Prese Sockets	G
	(mm)
Schuko	13
CEE 16A	55
CEE 32A	67
NEMA	1

Dati tecnici non impegnativi: NSM si riserva il diritto di apportare modifiche senza l'obbligo di darne preventiva comunicazione. Technical data not binding: NSM reserves the right to modify the contents without prior notice.