

ALTERNATORI MONOFASE - 2 Poli

SINGLE-PHASE ALTERNATORS - 2 Poles

K100
Brushless a condensatore
Brushless with Capacitor

KR100
A spazzole con AVR-d
Brush with AVR-d



| Caratteristiche tecniche |
|--|
| K100 |
| Tensione standard 50Hz: 230V, 240V 60Hz: 110/220V, 120/240V Altri valori a richiesta |
| Classe d'isolamento H |
| Protezione IP 23 |
| T.H.D. ≤ 6% |
| Precisione tensione + 5%, - 10% (cosφ = 1) |
| Capacità di spunto (Icc > 3In) |
| Optional Quadro elettrico, Carica batterie |
| KR100 |
| Tensione standard 50Hz: range 110÷120/220÷240V 60Hz: range 110÷120/220÷240V Altri valori a richiesta |
| Classe d'isolamento H |
| Protezione IP 23 |
| T.H.D. ≤ 6% |
| Precisione tensione ± 2% (indipendentemente dal cosφ) |
| Capacità di spunto (Icc > 3In) |
| Optional Quadro elettrico, Carica batterie |
| Regolatore automatico di tensione digitale AVR-d |

| Technical characteristics |
|--|
| K100 |
| Standard voltage 50Hz: 230V, 240V 60Hz: 110/220V, 120/240V Other voltages on request |
| Insulation class H |
| Protection IP 23 |
| T.H.D. ≤ 6% |
| Voltage accuracy + 5%, - 10% (cosφ = 1) |
| Starting capacity (Icc > 3In) |
| Optional Electrical panel, Battery charger |
| KR100 |
| Standard voltage 50Hz: range 110÷120/220÷240V 60Hz: range 110÷120/220÷240V Other voltages on request |
| Insulation class H |
| Protection IP 23 |
| T.H.D. ≤ 6% |
| Voltage accuracy ± 2% (regardless of cosφ) |
| Starting capacity (Icc > 3In) |
| Optional Electrical panel, Battery charger |
| Digital Automatic Voltage Regulator AVR-d |

| Modello Model | Potenza Output Power | | | Potenza assorbita Driving Power | | Potenza Output Power | | | Potenza assorbita Driving Power | | Peso Weight | | |
|------------------|----------------------|-------|----------|------------------------------------|-----|----------------------|-------|----------|------------------------------------|-----|----------------|------|------|
| | cosφ 1 | | cosφ 0,8 | 4/4 - cosφ 1 | | cosφ 1 | | cosφ 0,8 | 4/4 - cosφ 1 | | cone | B34 | SAE |
| | S1 | S2 | S1 | [kW] | η % | S1 | S2 | S1 | [kW] | η % | [kg] | [kg] | [kg] |
| | [kVA] | [kVA] | [kVA] | | | [kVA] | [kVA] | [kVA] | | | | | |

| | 50Hz - 3000rpm | | | | | 60Hz - 3600rpm | | | | | | | |
|-----------------|----------------|-----|-----|-----|------|----------------|-----|-----|-----|------|------|-----|-----|
| K100 B | 2,2 | 2,5 | --- | 3,1 | 70,0 | 2,7 | 3,0 | --- | 3,8 | 71,0 | 16,0 | --- | --- |
| K100 C | 2,7 | 3,0 | --- | 3,8 | 71,0 | 3,5 | 3,8 | --- | 4,9 | 72,0 | 17,0 | --- | --- |
| K100 D | 3,5 | 3,8 | --- | 4,9 | 72,0 | 4,5 | 4,8 | --- | 6,2 | 73,0 | 17,5 | --- | --- |
| K100 E | 4,2 | 4,5 | --- | 5,8 | 73,0 | 5,5 | 6,0 | --- | 7,4 | 74,0 | 20,0 | --- | --- |
| K100 F | 5,0 | 5,5 | --- | 6,7 | 75,0 | 6,0 | 6,5 | --- | 7,9 | 76,0 | 21,5 | --- | --- |
| K100 FX | 5,5 | 6,0 | --- | 7,3 | 75,5 | 6,5 | 7,0 | --- | 8,5 | 76,5 | 23,5 | --- | --- |
| K100 G | 6,0 | 6,5 | --- | 7,9 | 76,0 | 7,2 | 7,7 | --- | 9,4 | 77,0 | 25,0 | --- | --- |
| KR100 D | 3,5 | 3,8 | 2,8 | 4,9 | 71,0 | 4,2 | 4,5 | 3,3 | 5,8 | 72,0 | 17,5 | --- | --- |
| KR100 E | 4,2 | 4,5 | 3,3 | 5,8 | 72,0 | 5,0 | 5,5 | 4,0 | 6,8 | 73,5 | 20,0 | --- | --- |
| KR100 FX | 5,0 | 5,5 | 4,0 | 6,6 | 76,0 | 6,0 | 6,5 | 4,8 | 7,8 | 77,0 | 23,0 | --- | --- |
| KR100 G | 6,0 | 6,5 | 4,8 | 7,8 | 77,0 | 7,2 | 7,7 | 5,7 | 9,2 | 78,0 | 25,0 | --- | --- |

Dimensioni di ingombro

Overall Dimensions

CONE

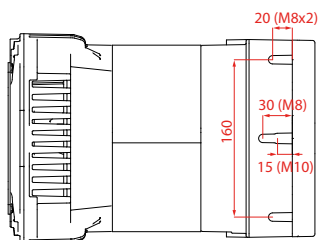
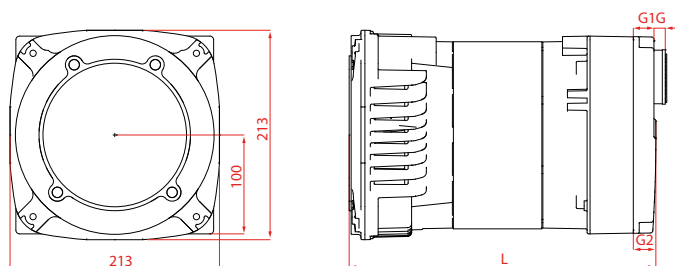

J609a

C 19

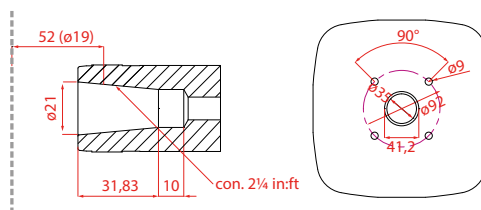

J609b

C 22
C 25,4

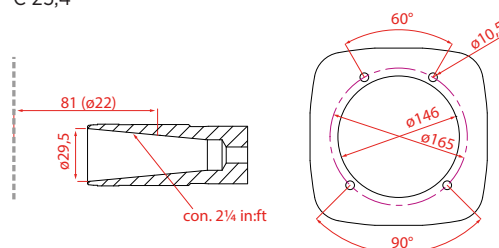

C 23

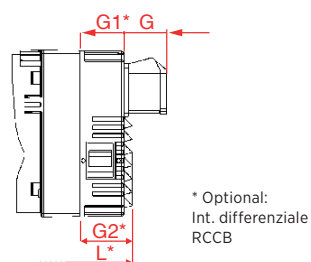
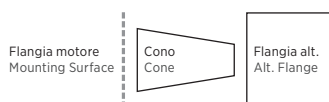
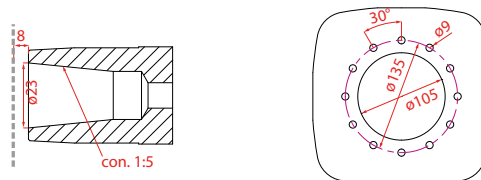

| | L | G1 | G2 |
|------------|------|------|---------------|
| | [mm] | | |
| K100 B | 299 | *337 | 21 *53 25 *63 |
| K100 C | 299 | *337 | 21 *53 25 *63 |
| K-KR100 D | 299 | *337 | 21 *53 25 *63 |
| K-KR100 E | 314 | *352 | 21 *53 25 *63 |
| K100 F | 324 | *362 | 21 *53 25 *63 |
| K-KR100 FX | 339 | *377 | 21 *53 25 *63 |
| K-KR100 G | 354 | *392 | 21 *53 25 *63 |

| Prese Sockets | G |
|-----------------|------|
| | [mm] |
| Schuko | 13 |
| CEE 16A | 55 |
| CEE 32A | 67 |
| NEMA | 1 |

Dati tecnici non impegnativi: NSM si riserva il diritto di apportare modifiche senza l'obbligo di darne preventiva comunicazione.

Technical data not binding: NSM reserves the right to modify the contents without prior notice.